

# Confex



## FACT SHEET

[koelncongress.de](http://koelncongress.de)

 **koelncongress**

conference | exhibition | event



**Flexible and scalable** – a major advantage for congresses, trade fairs and events of all sizes

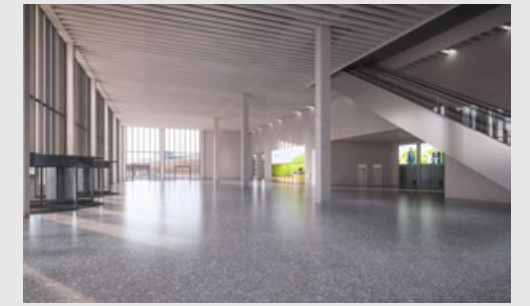

**Confex** – The new Conference and Exhibition Centre in Cologne - embedded in one of the most attractive city-centre trade fair grounds in the world.

Confex stands for the fusion between a conference venue and an exhibition space! 2 conference levels including 22 conference rooms ranging from 27 m<sup>2</sup> to 205 m<sup>2</sup>, a prestigious outdoor terrace and the real jewel, the Confex hall, which can be divided into three sections and has a total capacity of 4,300 people. The surrounding entrances to the Confex hall are directly connected to the light-flooded foyer, which offers sufficient space for receptions, relaxed breaks and staged side events, and directly adjoins the open-air plaza.

The building also boasts a scalable size, as it is integrated into one of the world's largest trade fair grounds. For the utmost flexibility in event planning, the Confex can be extended at any time to include additional rooms, halls and areas.

Another plus: the divisible Hall 1 and Hall 2.2, which are located in the immediate vicinity of the Confex, are directly connected to the Confex by a covered pedestrian bridge.

**The new all-rounder**

**Confex**  
hall 4,800m<sup>2</sup> and  
22 meeting rooms

**Direct connection to the Confex**

**Hall 1**  
9,619 m<sup>2</sup> / divisible

**Hall 2.1**  
9,580 m<sup>2</sup>

**Hall 2.2**  
9,736 m<sup>2</sup>

**Rooms West**  
5 Rooms

**Space for the very biggest ideas**

**11 trade fair halls**  
285,000 m<sup>2</sup> Exhibition space  
100,000 m<sup>2</sup> Outdoor space

**Congress Centre North & East**  
more than 40 event rooms

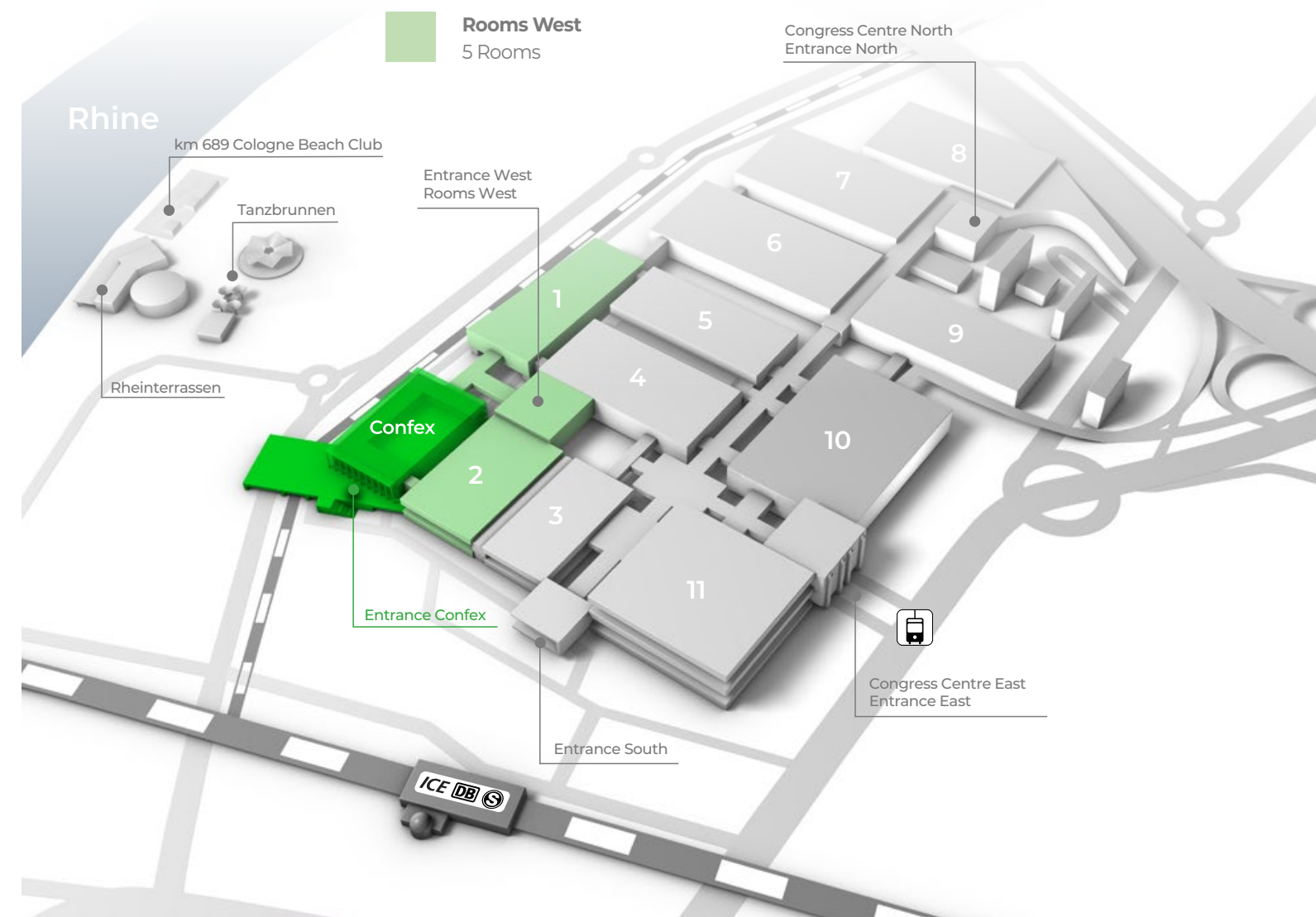

# Confex all levels

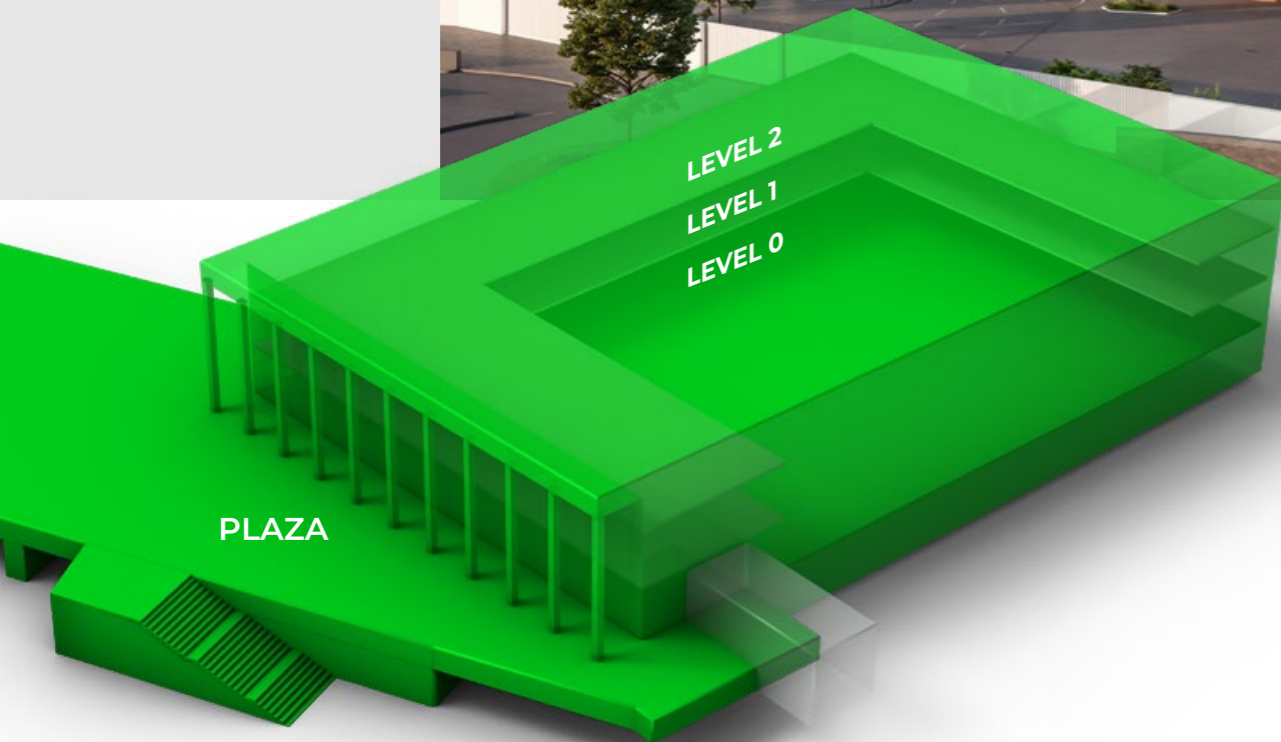

# Confexhall level 0

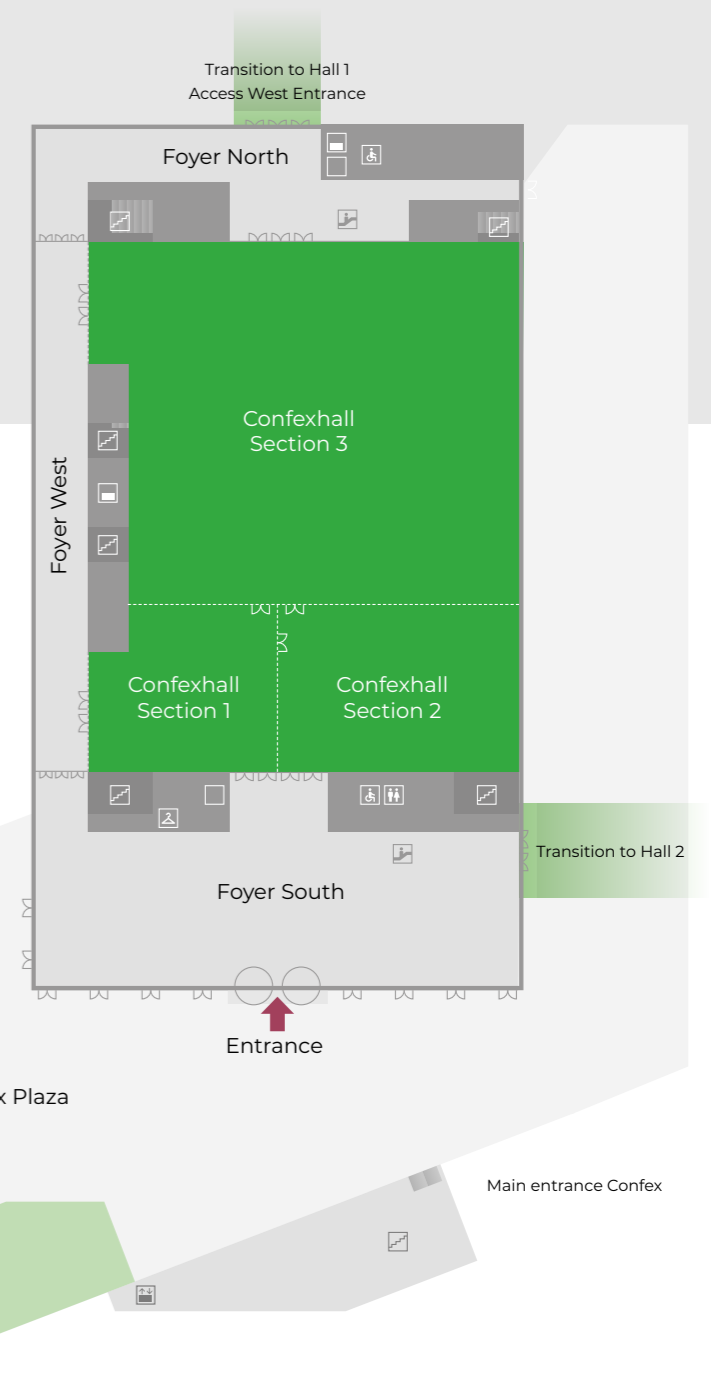
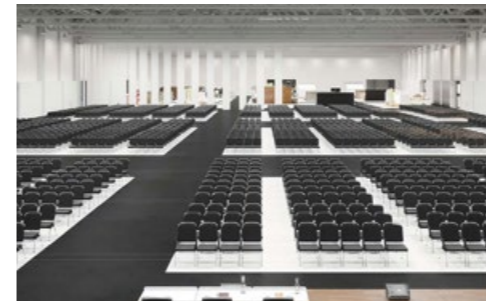
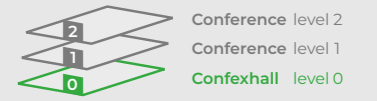

**Total capacity: 6,200 persons**

### Confexhall level 0

Section 1	647 m <sup>2</sup>
Section 2	899 m <sup>2</sup>
Section 3	3,255 m <sup>2</sup>
room height	12.20 m
Foyer South	1,970 m <sup>2</sup>
Foyer West	670 m <sup>2</sup>
Foyer North	698 m <sup>2</sup>
Plaza	5,600 m <sup>2</sup>
Total capacity	4,300 persons

### Conference level 1

Meeting rooms	10
Room sizes	27 m <sup>2</sup> to 96 m <sup>2</sup>
Room height	3.50 m
Foyer North	100 m <sup>2</sup>

### Conference level 2

Meeting rooms	12
Room sizes and between	200 m <sup>2</sup> - 60 m <sup>2</sup> - 90 m <sup>2</sup>
Room height	4.50 m
Foyer South	574 m <sup>2</sup>
Foyer West 1	123 m <sup>2</sup>
Foyer West 2	123 m <sup>2</sup>
Foyer North	146 m <sup>2</sup>

## Capacities

Room	Area	Height	Theatre	Classroom	Banquet	Block	Stage
Confexhall section 1+2+3	4,812 m <sup>2</sup>	12.20 m	4.300	2.564	3.360	-	8 x 30 m
Confexhall section 1+2	1,546 m <sup>2</sup>	12.20 m	1.332	710	990	-	5 x 15 m
Confexhall section 1	647 m <sup>2</sup>	12.20 m	540	300	390	-	5 x 10 m
Confexhall section 2	899 m <sup>2</sup>	12.20 m	804	446	660	-	5 x 10 m
Confexhall section 3	3,255 m <sup>2</sup>	12.20 m	3.208	1.946	2.490	-	6 x 20 m

# Conference level 1

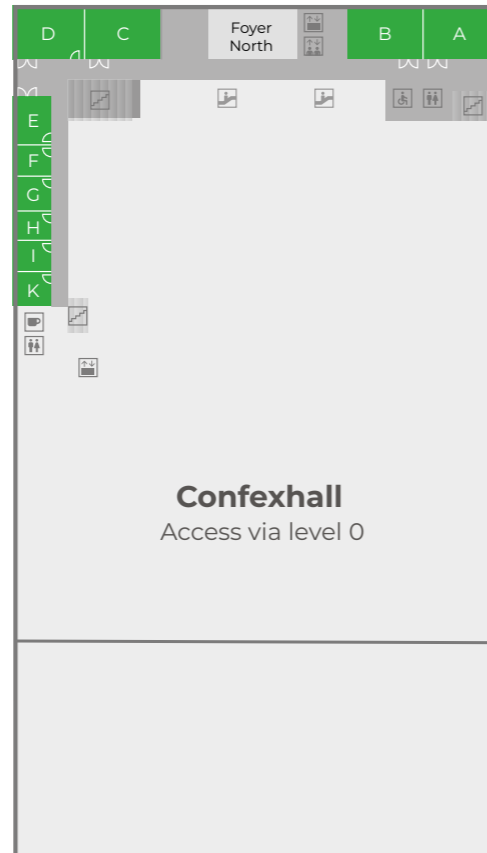
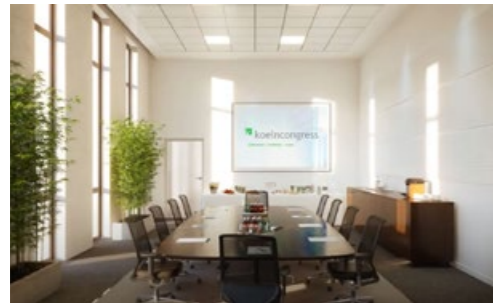
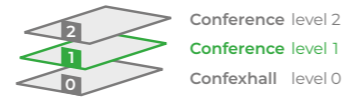

# Conference level 2

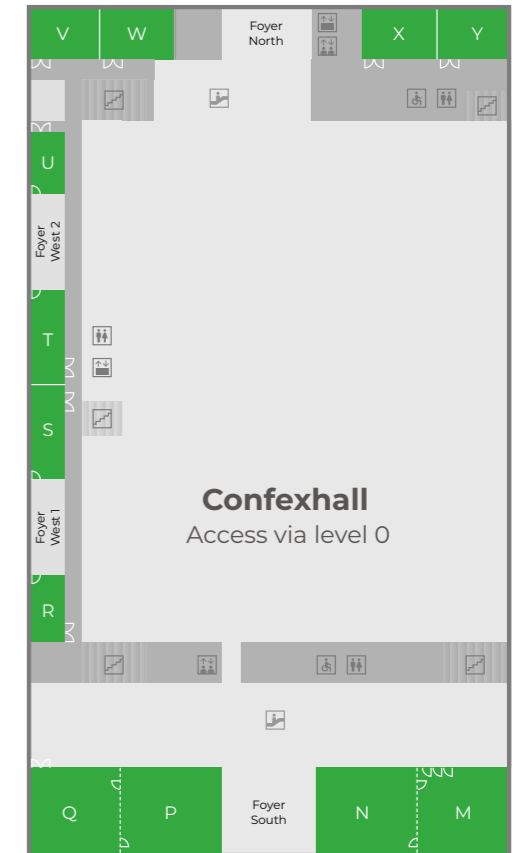
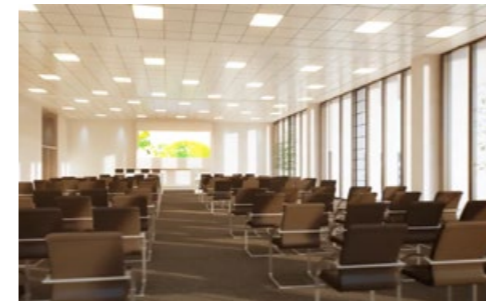
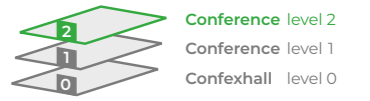

## Technical equipment of the conference rooms

### Audio\*

Rooms A-D in Conference Level 1 and Rooms N, M, P, Q, S, T and V-Y in Conference Level 2 have ceiling speakers for voice and announcements.

Also: wireless microphones, powered speakers, a hard-wired infrastructure, and a digital audio mixer.

All other, smaller rooms are equipped with powerful soundbars.

In the foyer areas there is the possibility of background sound and announcements.

## Capacities

Room	Area	Height	Theatre	Classroom	Banquet	Block	Stage
A	94 m <sup>2</sup>	3.50 m	90	54	50	-	2 x 3 m
B	96 m <sup>2</sup>	3.50 m	96	54	50	-	2 x 3 m
C	96 m <sup>2</sup>	3.50 m	96	54	50	-	2 x 3 m
D	95 m <sup>2</sup>	3.50 m	90	54	50	-	2 x 3 m
E	44 m <sup>2</sup>	3.50 m	40	24	20	-	2 x 3 m
F	27 m <sup>2</sup>	3.50 m	-	-	-	12	-
G	31 m <sup>2</sup>	3.50 m	-	-	-	16	-
H	27 m <sup>2</sup>	3.50 m	-	-	-	12	-
I	27 m <sup>2</sup>	3.50 m	-	-	-	12	-
K	31 m <sup>2</sup>	3.50 m	-	-	-	16	-

### Video\*

All rooms are equipped with LED displays. Depending on the size of the room, these are permanently installed 216" monitors or mobile 135", 90" or 70" monitors.

All screens are equipped with Barco ClickShare.

\*Audio and video equipment is included in the room rental.

### Darkening options

All Conference rooms have an internal translucent glare shield (anthracite, absorption value approx. 88).

### WiFi

Public visitor WiFi available in all rooms.

## Capacities

Room	Area	Height	Theatre	Classroom	Banquet	Block	Stage
M	195 m <sup>2</sup>	4.50 m	200	128	120	-	2 x 3 m
N	205 m <sup>2</sup>	4.50 m	200	144	120	-	2 x 3 m
M+N	404 m <sup>2</sup>	4.50 m	369	240	280	-	3 x 8 m
p	205 m <sup>2</sup>	4.50 m	200	142	120	-	2 x 3 m
Q	195 m <sup>2</sup>	4.50 m	200	128	120	-	2 x 3 m
P+Q	402 m <sup>2</sup>	4.50 m	369	240	280	-	3 x 8 m
R	60 m <sup>2</sup>	4.50 m	64	40	30	-	2 x 3 m
S	86 m <sup>2</sup>	4.50 m	96	56	60	-	2 x 3 m
T	86 m <sup>2</sup>	4.50 m	96	56	60	-	2 x 3 m
U	56 m <sup>2</sup>	4.50 m	49	30	20	-	2 x 3 m
V	95 m <sup>2</sup>	4.50 m	96	54	40	-	2 x 3 m
W	96 m <sup>2</sup>	4.50 m	96	60	40	-	2 x 3 m
X	96 m <sup>2</sup>	4.50 m	96	60	40	-	2 x 3 m
Y	94 m <sup>2</sup>	4.50 m	96	54	40	-	2 x 3 m

# Cologne the right place

- 3 international airports less than an hour away
- ICE (+ Eurostar via main station) highspeed trains + public transport in walking distance
- 10,000 parking lots onsite ( 7,500 additional parking lots in the vicinity of Koelnmesse)
- 6 hotels (international brands) in walking distance
- 280 hotels (36,000 beds)



Confex

Congress-Centrum  
Koelnmesse

Gürzenich Köln

Flora Köln

Tanzbrunnen Köln



km 689  
COLOGNE BEACH CLUB

**Koelncongress GmbH**  
Messeplatz 1  
50679 Cologne  
Sales:  
Phone: +49 221 821-3080  
sales@koelncongress.de  
koelncongress.de/confex

**Catering**  
Our catering partner at the Confex:  
  
Koelncongress Gastronomie GmbH  
Phone: +49 151 19 79 15 65  
sales.confex@koelncongress-gastro.de  
koelncongress-gastronomie.de

 [linkedin.com/company/koelncongress-gmbh](https://www.linkedin.com/company/koelncongress-gmbh)

 **koelncongress**

conference | exhibition | event